

1 **2" MULLION**
FOR SERIES 8200 / 8200

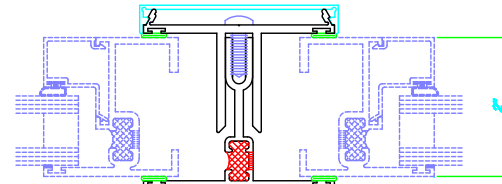

2 **2 3/4" MULLION**
FOR SERIES 8200 / 8200

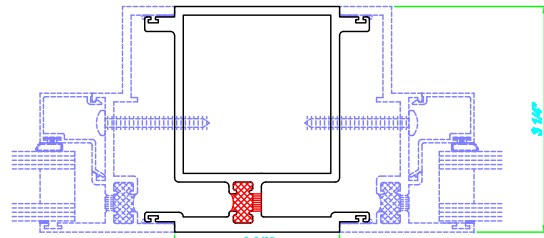

3 **2 3/8" MULLION**
FOR SERIES 8200

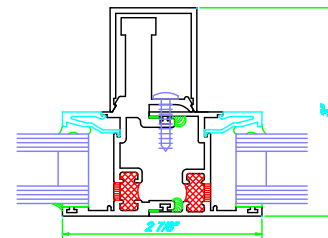

4 **3" MULLION**
FOR SERIES 8100

MULLIONS

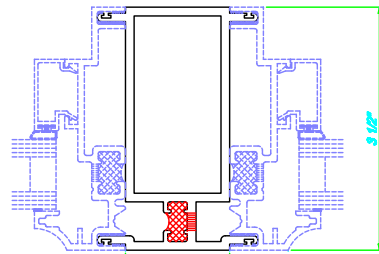

5 **STRUCTURAL MULLION**
FOR SERIES 8300

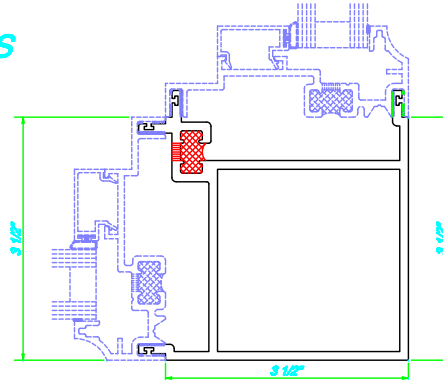

6 **90° CORNER MULLION**
FOR SERIES 8300

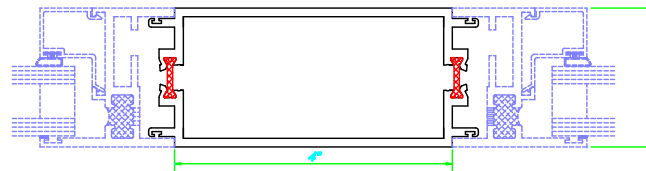

7 **4" MULLION**
FOR SERIES 8200 / 8200